

U1 CNOMO 2/2 - 3/2 Electropilot for mounting on sub-bases SPEED U2



Material:	
valve body	technopolymer
sleeve	treated brass
core and spring	stainless steel
seals	nitrile rubber

Weight (Kg): 0,155

	Symbol	Ø (d) mm	Flow rate (Nl/min)		Times (ms)		Manual override	Part no.
			1 → 2	2 → 3	En.	De-en.		
3/2 NC		1,5	45	77	12	12	⊖	AA-0400
		1,5	45	77	12	12	→	AA-0400U
2/2 NC		1,3	42	-	-	-	⊖	AA-0402
3/2 NO (b)		1,2	33	77	11	10	(c)	AA-0404

Sub-base: SPEED U2. Available upon request: brass valve body (without manual override).
Zamak valve body. Stainless steel sleeve - other inner diameters.

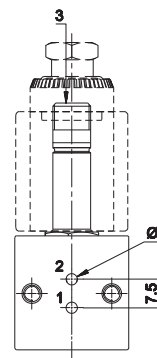
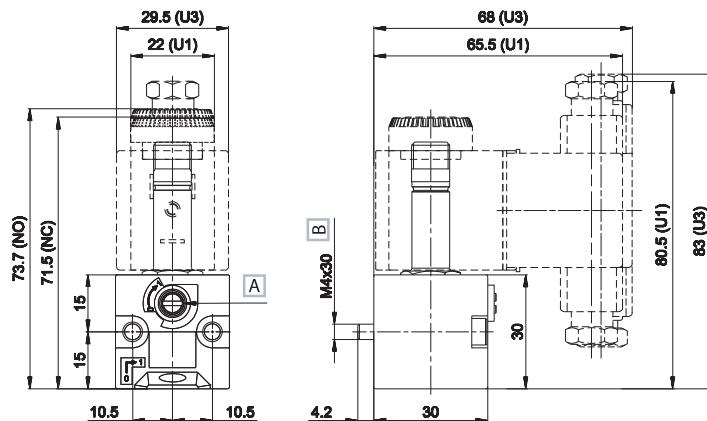

A Manual override
B ISO 4762

1 = Supply port
2 = Use
3 = Exhaust

Modular sub-base "SPEED" series U1/U2 G1/8



Electropilot	Connections	Material	Weight Kg	Part no.
U1 for base	G 1/8	zamak	0,037	AA-0450
U2 for base	G 1/8	zamak	0,075	AB-0900

Advantages

The original UNIVER "Speed" series was designed to solve some operational problems

- Possibility of defining the number of sub-bases at the moment of use
- Possibility of freely increasing or reducing the number of elements
- Quick assembly with special screw (built-in) standard supplied
- Reduction of stock holding
- Easy technical intervention

Air supply is rotated by 90° in comparison with side consumption
Standard (built-in) screw and O-Ring

When assembling the manifold, put the bases on a flat surface and tighten the screw until the manifold is perfectly aligned.

(b) = close the exhaust of the 3/2 NO electropilot to get the 2/2 NO one
(d) = the Ø shown on the 3/2 valves refers to the exhaust

Electropilots are supplied without coil, connector and locking ring

(c) = manual override on ring nut AM-5201

⊖ = with 2 position screw
→ = with button with tool

■ U1

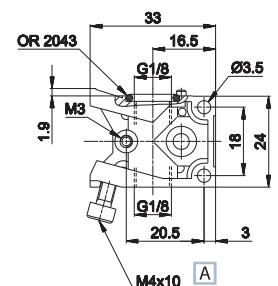
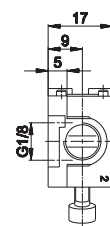

■ U2

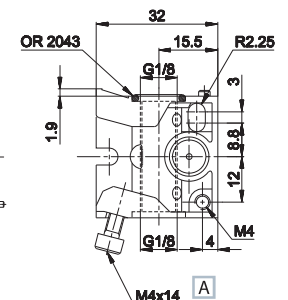
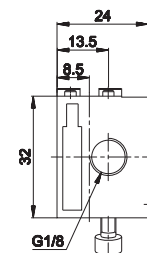

A ISO 4762