

2502

Male connector BSPP thread with OR

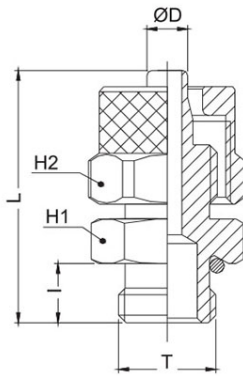

| CODE | T | ØD | I | L | H1 | H2 | GR. |
|---------------|-------|---------|----|------|----|----|------|
| 2502TR18427 | G1/8" | 4/2,7 | 6 | 21,8 | 13 | 8 | 10,0 |
| 2502TR1853 | G1/8" | 5/3 | 6 | 23,0 | 15 | 8 | 11,0 |
| 2502TR1864 | G1/8" | 6/4 | 6 | 25,5 | 13 | 12 | 16,0 |
| 2502TR1464 | G1/4" | 6/4 | 8 | 28,0 | 16 | 12 | 21,0 |
| 2502TR3864 | G3/8" | 6/4 | 9 | 29,0 | 19 | 12 | 26,0 |
| 2502TR1264 | G1/2" | 6/4 | 10 | 30,5 | 24 | 12 | 45,0 |
| 2502TR1886 | G1/8" | 8/6 | 6 | 25,5 | 14 | 14 | 18,0 |
| 2502TR1486 | G1/4" | 8/6 | 8 | 28,0 | 16 | 14 | 22,0 |
| 2502TR3886 | G3/8" | 8/6 | 9 | 29,0 | 19 | 14 | 31,0 |
| 2502TR1286 | G1/2" | 8/6 | 10 | 30,5 | 24 | 14 | 38,0 |
| 2502TR18108 | G1/8" | 10/8 | 6 | 27,5 | 14 | 16 | 24,0 |
| 2502TR14108 | G1/4" | 10/8 | 8 | 29,5 | 16 | 16 | 28,0 |
| 2502TR38108 | G3/8" | 10/8 | 9 | 30,5 | 19 | 16 | 32,0 |
| 2502TR12108 | G1/2" | 10/8 | 10 | 32,0 | 24 | 16 | 51,0 |
| 2502TR381210 | G3/8" | 12/10 | 9 | 32,0 | 19 | 18 | 36,0 |
| 2502TR121210 | G1/2" | 12/10 | 10 | 33,5 | 24 | 18 | 46,0 |
| 2502TR1215125 | G1/2" | 15/12,5 | 10 | 35,5 | 24 | 22 | 52,0 |

2503

Swivel male connector BSPP thread with OR

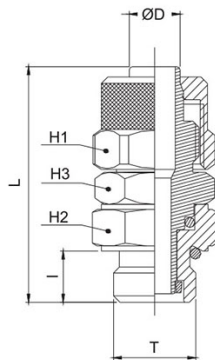

| CODE | T | ØD | I | L | H1 | H2 | H3 | GR. |
|--------------|-------|--------|---|------|----|----|----|-------|
| 2503TR1864 | G1/8" | 6/4 | 6 | 36,0 | 12 | 13 | 12 | 24,0 |
| 2503TR1464 | G1/4" | 6/4 | 8 | 37,5 | 12 | 16 | 14 | 30,0 |
| 2503TR1885 | G1/8" | 8/5 | 6 | 36,0 | 14 | 12 | 13 | 0,026 |
| 2503TR1485 | G1/4" | 8/5 | 8 | 37,5 | 14 | 14 | 16 | 0,032 |
| 2503TR1886 | G1/8" | 8/6 | 6 | 36,0 | 14 | 13 | 12 | 26,0 |
| 2503TR1486 | G1/4" | 8/6 | 8 | 37,5 | 14 | 16 | 14 | 32,0 |
| 2503TR141065 | G1/4" | 10/6,5 | 8 | 39 | 16 | 14 | 16 | 0,038 |
| 2503TR14108 | G1/4" | 10/8 | 8 | 39,0 | 16 | 16 | 14 | 38,0 |
| 2503TR38128 | G3/8" | 12/8 | 9 | 42 | 18 | 17 | 19 | 0,05 |
| 2503TR381210 | G3/8" | 12/10 | 9 | 42,0 | 18 | 19 | 17 | 52,0 |

