

5020

Male elbow barb connector BSPT thread

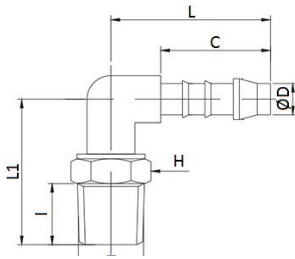

CODE	T	ØD	I	C	L	L1	H	GR.
5020TR184	R1/8"	4	8,0	16,0	22,5	21,0	11	1,0
5020TR144	R1/4"	4	10,0	16,0	22,5	24,0	14	1,0
5020TR185	R1/8"	5	8,0	21,0	28,0	24,0	11	1,0
5020TR145	R1/4"	5	10,0	21,0	28,0	26,0	14	3,0
5020TR125	R1/2"	5	13,0	21,0	28,0	30,0	22	6,0
5020TR186	R1/8"	6	8,5	23,5	31,5	23,5	11	1,0
5020TR146	R1/4"	6	10,0	23,0	31,0	26,0	14	3,0
5020TR386	R3/8"	6	10,5	23,0	31,0	26,0	17	3,0
5020TR126	R1/2"	6	13,0	23,5	31,5	30,0	22	7,0
5020TR188	R1/8"	8	8,0	25,0	36,0	26,0	11	3,0
5020TR148	R1/4"	8	10,0	25,0	36,0	28,0	14	3,0
5020TR388	R3/8"	8	10,5	25,0	36,0	28,0	17	5,0
5020TR128	R1/2"	8	13,0	25,0	36,0	30,5	22	7,0
5020TR1410	R1/4"	10	10,0	27,0	39,0	28,0	14	4,0
5020TR3810	R3/8"	10	10,5	27,0	39,0	28,0	17	6,0
5020TR1210	R1/2"	10	13,0	27,0	39,0	30,5	22	8,0
5020TR3410	R3/4"	10	14,5	27,0	39,0	33,5	27	9,9
5020TR1412	R1/4"	12	10,0	28,0	41,0	28,0	14	7,0
5020TR3812	R3/8"	12	10,5	28,0	41,0	28,0	17	8,0
5020TR1212	R1/2"	12	13,0	28,0	41,0	32,0	22	9,0
5020TR3412	R3/4"	12	14,5	28,0	41,0	34,0	27	12,0
5020TR3814	R3/8"	14	10,5	29,5	42,5	31,5	17	9,0
5020TR1214	R1/2"	14	13,0	29,5	42,5	34,0	22	11,0
5020TR3414	R3/4"	14	14,5	29,5	42,5	37,5	27	14,4
5020TR1216	R1/2"	16	12,5	30,0	44,0	36,0	22	13,0
5020TR3416	R3/4"	16	14,5	30,0	44,0	39,0	27	14,0
5020TR1219	R1/2"	19	12,5	31,0	45,0	36,0	22	15,0
5020TR3419	R3/4"	19	15,0	31,0	45,0	38,0	27	16,6

