

## WTRLL-G

Long swivel male elbow BSPP & metric thread nickel plated

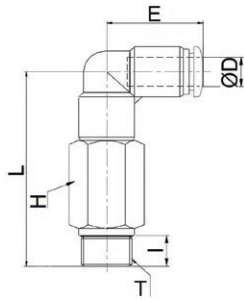

CODE	ØD	T	I	L	E	H	GR.
WTRLL04M5	4	M5X0,8	3,8	29,3	17,5	8,0	10,4
WTRLL04M6	4	M6X1	4,5	30,0	17,5	8,0	10,8
WTRLL04G01	4	G1/8"	5,0	36,0	17,5	14,0	25,9
WTRLL04G02	4	G1/4"	5,8	37,3	17,5	17,0	26,6
WTRLL06M5	6	M5X0,8	3,8	31,3	19,0	8,0	11,4
WTRLL06M6	6	M6X1	4,5	32,0	19,0	8,0	11,8
WTRLL06G01	6	G1/8"	5,0	39,2	19,0	14,0	30,5
WTRLL06G02	6	G1/4"	5,8	40,5	19,0	17,0	43,3
WTRLL06G03	6	G3/8"	6,8	42,0	19,0	20,0	57,0
WTRLL06G04	6	G1/2"	8,0	43,2	19,0	24,0	91,5
WTRLL08G01	8	G1/8"	5,0	41,3	22,8	14,0	35,4
WTRLL08G02	8	G1/4"	5,8	42,6	22,8	17,0	48,0
WTRLL08G03	8	G3/8"	6,8	44,1	22,8	20,0	60,3
WTRLL08G04	8	G1/2"	8,0	45,3	22,8	24,0	93,7
WTRLL10G01	10	G1/8"	5,0	49,0	26,3	17,0	61,8
WTRLL10G02	10	G1/4"	5,8	49,8	26,3	17,0	68,7
WTRLL10G03	10	G3/8"	6,8	51,3	26,3	20,0	78,7
WTRLL10G04	10	G1/2"	8,0	53,5	26,3	24,0	105,8
WTRLL12G02	12	G1/4"	5,8	56,8	29,6	20,0	98,1
WTRLL12G03	12	G3/8"	6,8	57,8	29,6	20,0	101,9
WTRLL12G04	12	G1/2"	8,0	59,5	29,6	24,0	124,3

## WTRLL-N

Long swivel male elbow NPT & UNF thread nickel plated

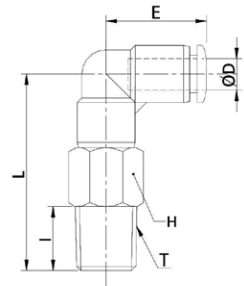

CODE	ØD	T	A	B	E	H	LB
WTRLL532UF1032	5/32	UNF 10-32	0,149	1,318	0,688	0,437	0,029
WTRLL532N01	5/32	N1/8"	0,295	1,417	0,688	0,437	0,031
WTRLL316N01	3/16	N1/8"	0,295	1,417	0,700	0,437	0,046
WTRLL316N02	3/16	N1/4"	0,413	1,555	0,700	0,562	0,061
WTRLL316N03	3/16	N3/8"	0,433	1,594	0,700	0,685	0,082
WTRLL1-4N01	1/4	N1/8"	0,295	1,562	0,748	0,5	0,048
WTRLL1-4N02	1/4	N1/4"	0,413	1,700	0,748	0,562	0,064
WTRLL1-4N03	1/4	N3/8"	0,433	1,740	0,748	0,685	0,086
WTRLL516N01	5/16	N1/8"	0,295	1,665	0,897	0,562	0,076
WTRLL516N02	5/16	N1/4"	0,413	1,783	0,897	0,562	0,073
WTRLL516N03	5/16	N3/8"	0,433	1,822	0,897	0,685	0,100
WTRLL38N02	3/8	N1/4"	0,413	2,047	1,035	0,685	0,137
WTRLL38N03	3/8	N3/8"	0,433	2,106	1,035	0,685	0,125
WTRLL38N04	3/8	N1/2"	0,551	2,244	1,035	0,874	0,192
WTRLL1-2N02	1/2	N1/4"	0,413	2,342	1,165	0,874	0,191
WTRLL1-2N03	1/2	N3/8"	0,433	2,362	1,165	0,874	0,222
WTRLL1-2N04	1/2	N1/2"	0,551	2,480	1,165	0,874	0,197

