

6200

Cone-shaped silencer of sinterized spherical bronze riveted on hexagonal brass base

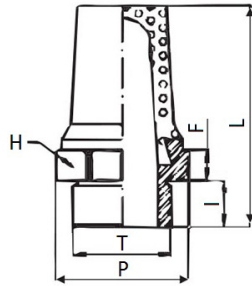

CODE	T	ØP	I	F	L	H	GR.
6200TRM5	M5	7,5	3,5	4,0	18,5	8	2,5
6200TR18	G1/8"	12,5	6,0	4,0	26,0	13	9,5
6200TR14	G1/4"	14,5	6,0	5,0	34,0	16	16,5
6200TR38	G3/8"	19,0	8,0	5,0	41,0	19	26,5
6200TR12	G1/2"	22,5	8,0	6,0	46,0	24	46,5
6200TR34	G3/4"	28,5	10,0	6,0	56,0	30	81,5
6200TR1	G1"	35,0	10,0	6,0	66,0	36	134,0

6250

Hexagonal head cone-shaped silencer of sinterized spherical bronze riveted on circular brass base

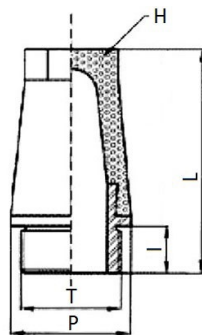

CODE	T	ØP	I	L	H	GR.
6250TR18	G1/8"	13,0	7,0	27,0	6,0	8,5
6250TR14	G1/4"	16,0	8,0	30,0	7,0	13
6250TR38	G3/8"	19,0	8,0	40,0	10,0	23
6250TR12	G1/2"	24,0	10,0	46,0	13,0	40
6250TR34	G3/4"	30,0	10,0	54,0	17,0	73,5
6250TR1	G1"	38,0	10,0	61,0	22,0	145

6300

Silencer of sinterized spherical bronze riveted on hexagonal brass pastille base

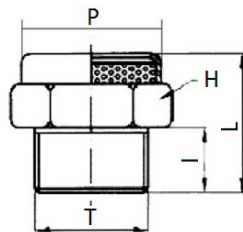

CODE	T	ØP	I	L	H	GR.
6300TRM5	M5	6,5	4,0	8,5	8	2,0
6300TR18	G1/8"	11,0	6,0	12,0	13	6,5
6300TR14	G1/4"	15,5	8,0	16,0	16	11,0
6300TR38	G3/8"	18,5	8,0	17,0	19	16,5
6300TR12	G1/2"	22,0	10,0	18,0	24	26,0
6300TR34	G3/4"	28,0	10,0	19,0	30	39,5
6300TR1	G1"	34,0	10,0	20,0	36	60,0

6350

Silencer of sinterized spherical bronze riveted on circular knurled brass pastille base

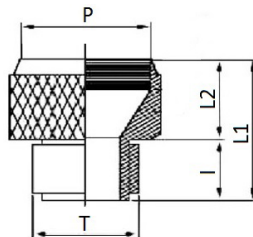

CODE	T	ØP	I	L1	L2	GR.
6350TR18	G1/8"	11,0	7,0	13,0	6,0	7,0
6350TR14	G1/4"	14,0	8,0	16,0	6,0	7,0
6350TR38	G3/8"	17,0	8,0	14,0	6,0	10,0
6350TR12	G1/2"	22,0	10,0	18,0	8,0	10,0
6350TR34	G3/4"	28,0	10,0	18,0	10,0	12,0
6350TR1	G1"	34,0	10,0	19,0	9,0	12,0

