

**WTRW-N**

Reduced union Y

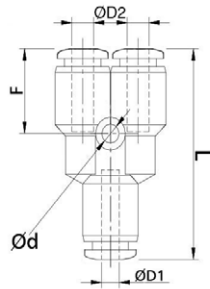

CODE	ØD1	ØD2	Ød	L	F	LB
WTRW316-532	3/16	5/32	0,125	1,409	0,551	0,019
WTRW1-4-532	1/4	5/32	0,125	1,448	0,570	0,020
WTRW1-4-316	1/4	3/16	0,125	1,460	0,582	0,021
WTRW516-1-4	5/16	1/4	0,125	1,570	0,696	0,025
WTRW38-516	3/8	5/16	0,165	1,885	0,799	0,048
WTRW1-2-38	1/2	3/8	0,165	2,031	0,787	0,064

**WTRZA**

Union cross

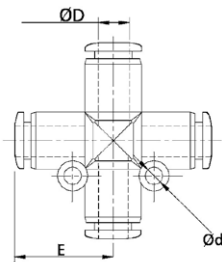

CODE	ØD	Ød	E	GR.
WTRZA0400	4	3,2	17,5	8,0
WTRZA0600	6	3,2	19,3	10,2
WTRZA0800	8	3,2	22,75	13,6
WTRZA1000	10	4,2	27,0	28,2
WTRZA1200	12	4,3	29,6	34,2

**WTRZA-N**

Union cross

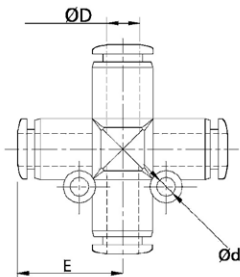

CODE	ØD	Ød	E	LB
WTRZA532	5/32	0,125	0,688	0,017
WTRZA316	3/16	0,125	0,700	0,021
WTRZA1-4	1/4	0,125	0,759	0,022
WTRZA516	5/16	0,125	0,895	0,029
WTRZA38	3/8	0,165	1,062	0,062
WTRZA1-2	1/2	0,169	1,165	0,075

**WTRK**

Union multi tee

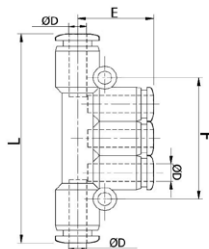

CODE	ØD	F	E	L	GR.
WTRK04	4	36	19	57,0	13,0
WTRK06	6	42	20,3	61,6	17,0
WTRK08	8	48	24,3	81,6	22,0

